

**TAKING A CLOSE LOOK AT YOUR OWN LATCH ASSEMBLY WILL HELP IN THE DISASSEMBLING AND REASSEMBLING OF YOUR LATCH. WE STRONGLY RECOMMEND THAT YOU READ THESE INSTRUCTIONS WHILE CLOSELY LOOKING AT YOUR LATCH ASSEMBLY.**

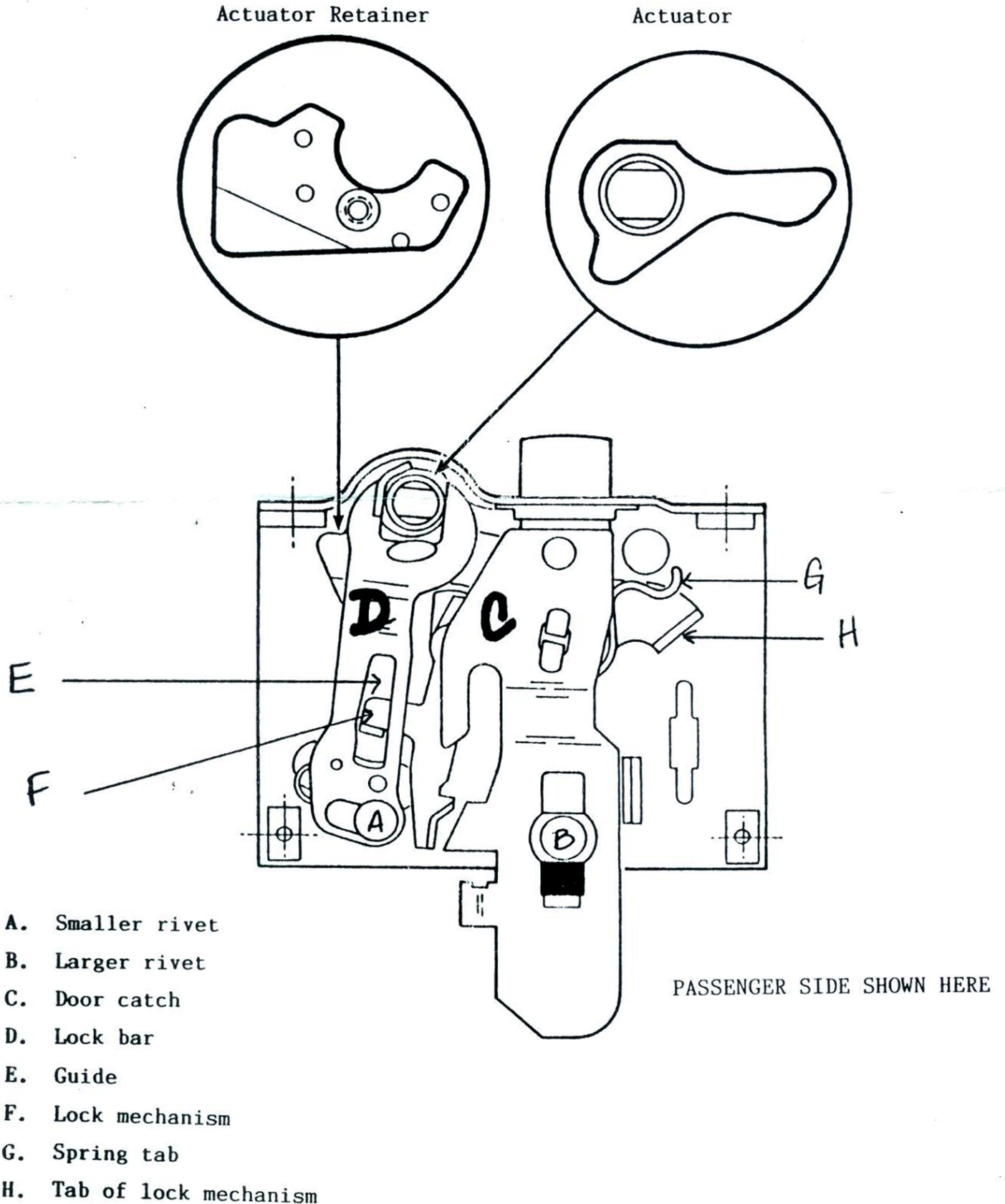

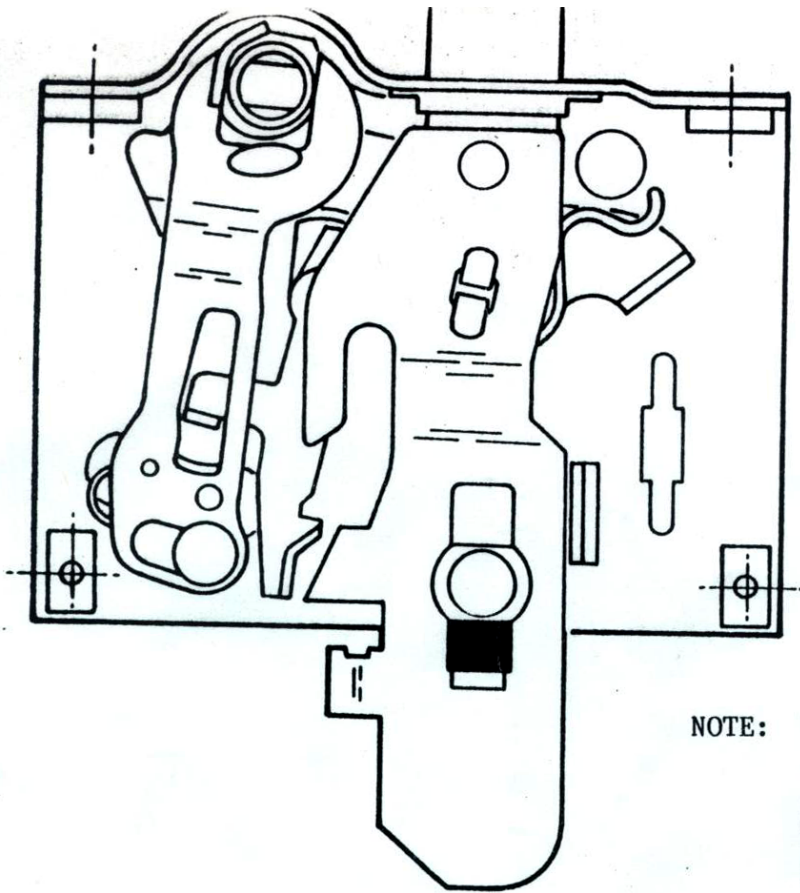

NOTE: WE CANNOT BE RESPONSIBLE FOR ANY DAMAGES DONE OR DAMAGES CAUSING MISFUNCTION OF LATCH ASSEMBLY. READ ALL INSTRUCTIONS BEFORE ATTEMPTING TO DISASSEMBLE YOUR LATCH.

1. Clean latch assembly in solvent.
2. Drill out rivets (A) and (B) from the reverse side using a 3/16" drill bit.  
 Once rivet (B) is drilled out the door catch can be removed.  
 Once rivet (A) is drilled out the lock bar can be removed.
3. Drill the three rivets on the reverse side of the latch assembly that hold the actuator retainer using a 15/64" drill bit. See Illustration 2.
4. Remove the actuator. Turn the latch assembly over and from the reverse side using a pair of vise grips squeeze the actuator in 2-3 places and remove.

Illustration 2.

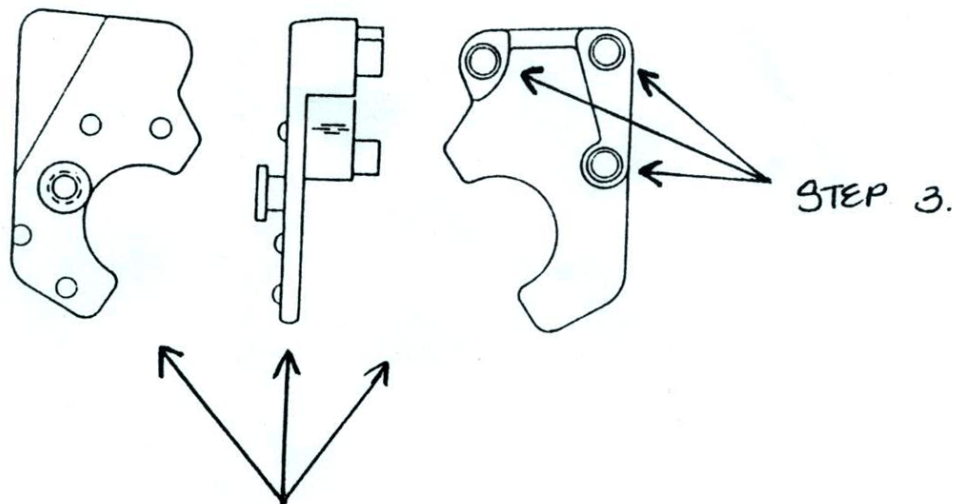

PASSENGER SIDE SHOWN HERE

Slide back

bracket  
w/ bumper  
(only bumper  
shows through to  
front side)

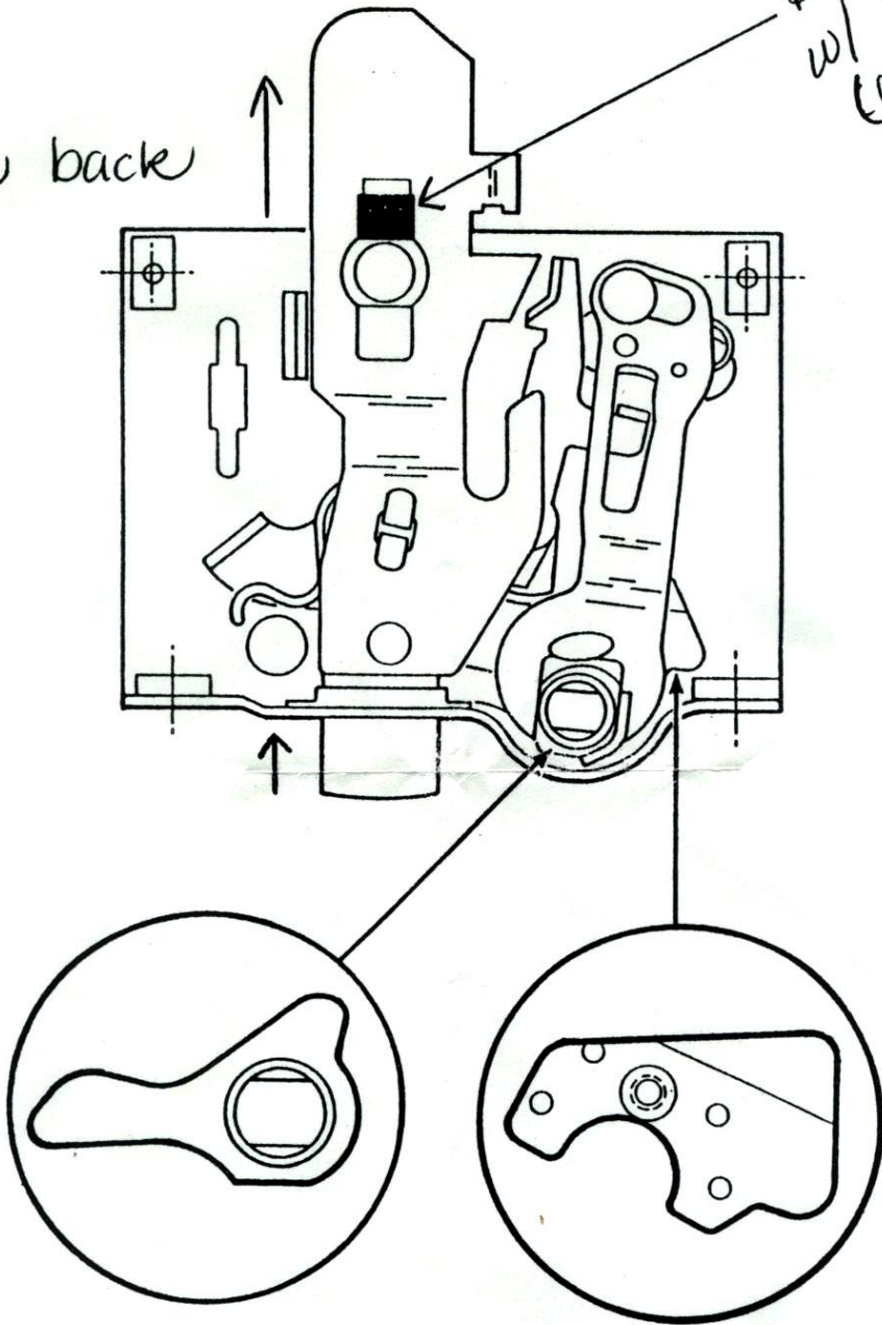



ACTUATOR →

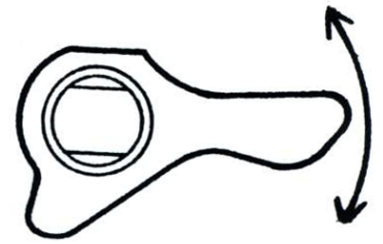

## REASSEMBLY

1. Replace actuator - Hold actuator in place while placing the latch assembly **FRONT SIDE DOWN** in a vise. Place only the short adjacent side in vise. DO NOT OVER TIGHTEN.
2. Heat actuator evenly but careful not to over-heat. Place ball side of ball-peen hammer against center of actuator and tap with another hammer. This should peen edges over to hold in place. Actuator should be able to move freely. Grease a small amount once this is installed.
3. Trial fit lock bar to actuator retainer place. File two lower nipples if needed. See illustration below.

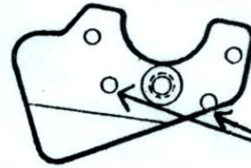

FILE HERE IF NEEDED

4. Install actuator retainer plate. Use a small peice of wood under half of the retainer plate before peening over edges. Do not smash the stem in the middle of the actuator retainer.

PLACE WOOD HERE →

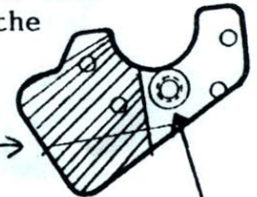

STEM

5. ~~Put small spring into hole on latch assembly plate. Slide lock bar onto actuator retainer and install spring into smaller hole on lock bar. Be certain that the lock mechanism is properly in the guide.~~
6. Put smaller rivet in place and hold in place with thumb. Test lock bar by sliding side to side. Lock bar should stay in position. If it doesn't, the small spring has not been installed correctly. Once testing proves successful, peen over edges of rivets.
7. Remove old coil spring. Take note of spring position. Replace with new spring and spring retainer. Bend "ears" over.
8. Remove old rubber from bracket and replace with bumper contained in kit. Slide door catch into place. With a pair of pliers lift spring tab over tab of lock mechanism.
9. Slide door catch back. Place bracket with bumper on the reverse side of latch assembly. Place large rivet with tension washer on the front side holding with thumb and forefinger. Peen edges of rivet over.

